

SKF Multilube pumping unit

for single-, dual-line and progressive lubrication systems



SKF Multilube pumping unit

The SKF Multilube pumping unit is an effective solution for lubricating individual machines and equipment.

This compact pumping unit, which is easy to install and operate, ensures functionality in machine and equipment specific applications, even when used outdoors.

Centralised Lubrication Improves Runnability

The high-quality SKF Multilube pumping unit helps to prevent bearing failures and improves the runnability of machines and equipment. The centralised lubrication system helps to ensure that the lubrication result is optimal, thereby reducing energy and lubricant consumption.

Compact and Flexible Solution

All relevant components and functions (control unit, pump, reservoir, directional valve and pressure monitoring) are integrated into the modular pumping unit of the SKF Multilube pumping unit. Built-in heating allows it to be operated even under demanding and cold circumstances.

All SKF grease and oil dosers for single and dual-line systems can be used with the SKF Multilube pumping unit. Auxiliary equipment, such as spray and sliding surface nozzles and lubrication brushes, can be used depending on lubrication needs.

1. Supporting block
2. Pressure control unit
3. Lubricant outlets
4. Pumping element
5. Low level switch
6. Heating element
7. Line valve
8. Power supply
9. Electrical connections
10. Control unit
11. Electric motor
12. Filling safety valve
13. Filling connector with filter
14. Pressure relief valve
15. Visual level indicator
16. Follower piston

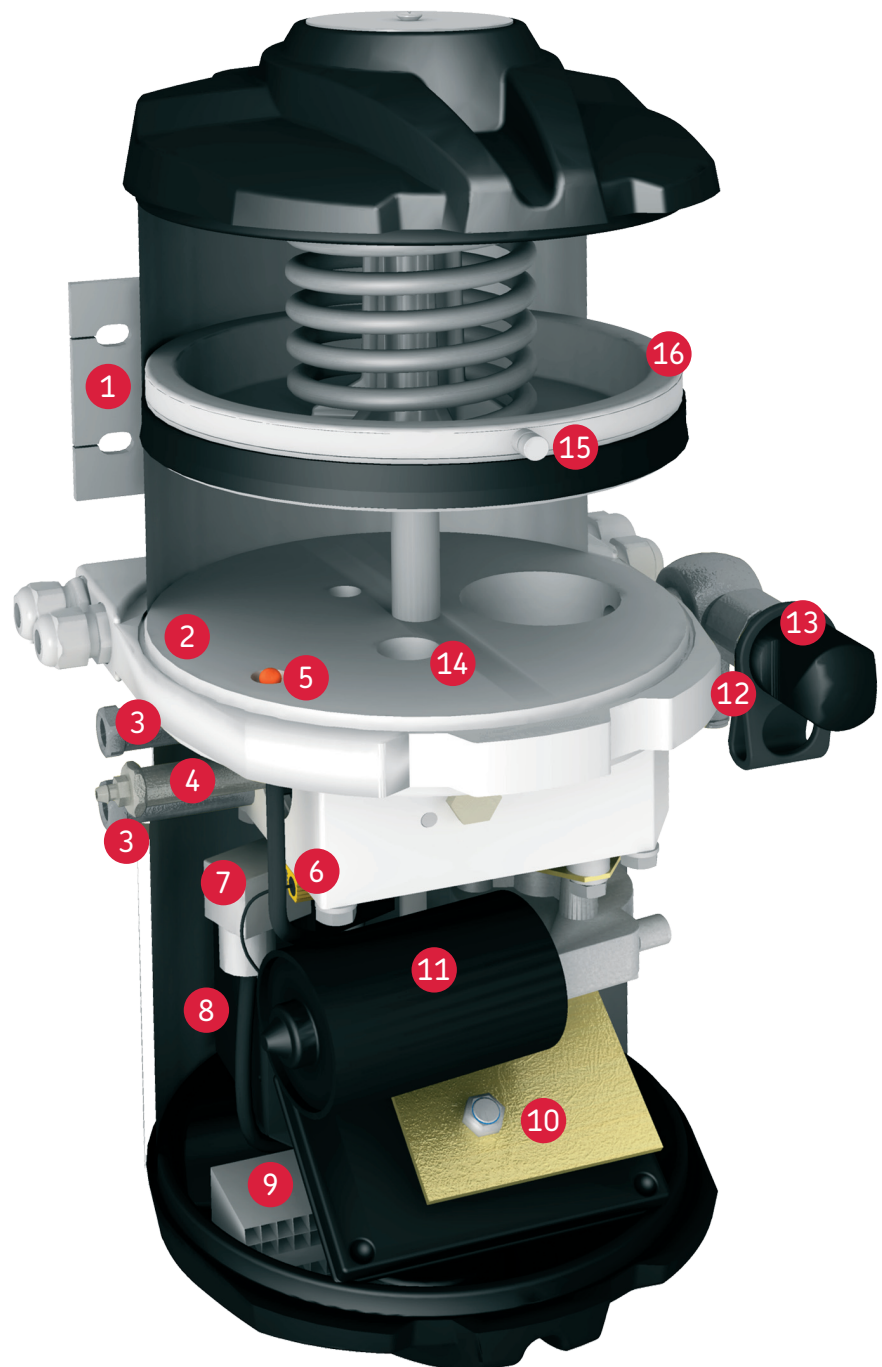

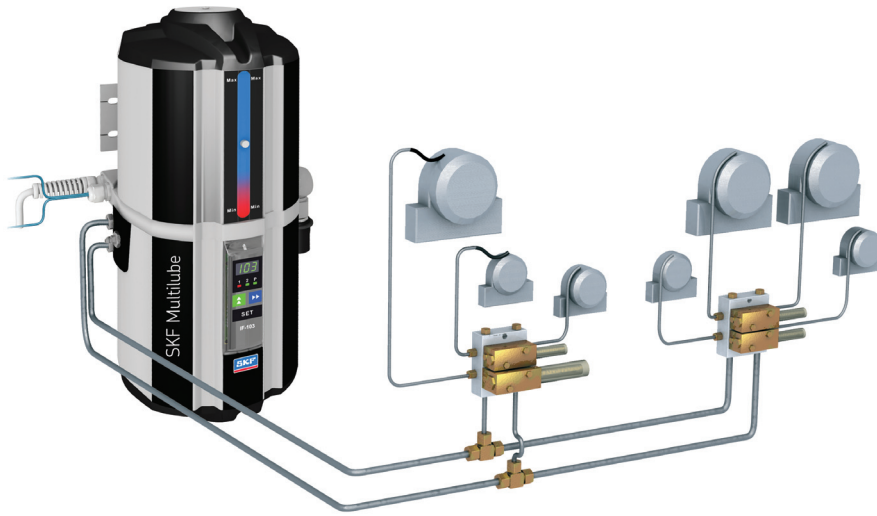

Dual line centralised lubrication system with SG2 and SMG dosers

Lubricant greases NLGI 000 – NLGI 2
 SGA doser range 0,15–8,68 g
 SMG doser range 0,13–1,32 g

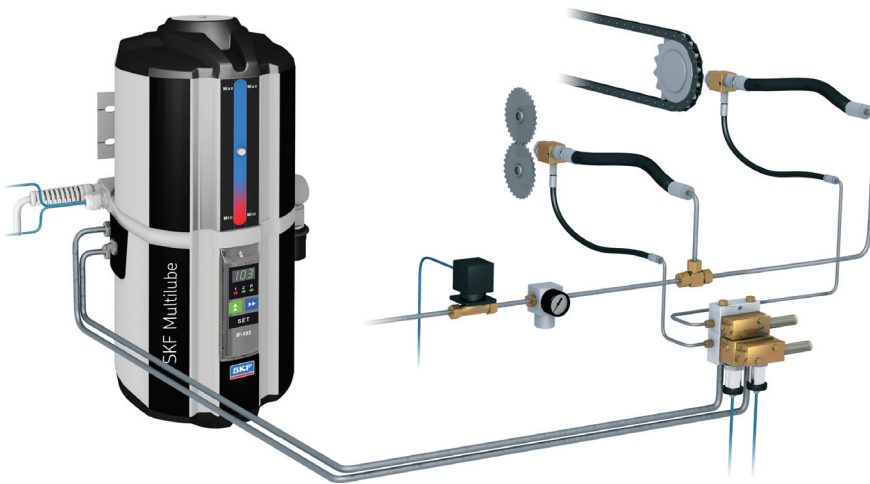

Dual line spraying lubrication system with SG2 dosers

Lubricant greases NLGI 000–NLGI 2
 SGA doser range 0,15–8,68 g

SKF Multilube pumping unit MLP

	Reservoir 4 l	10 l
Max. output	13 g/min	13 g/min
Reservoir	4 l	10 l
Max. pressure	210 bar (3 045 psi)	210 bar (3 045 psi)
Operation temperature range	-30 to +70 °C (-22 to +158 °F)	-30 to +70 °C (-22 to +158 °F)
Lubrication line connections	R 1/4 in.	R 1/4 in.
Lubricant	NLGI up to 2	NLGI up to 2
Power supply	24 VDC, 115 VAC or 230 VAC	24 VDC, 115 VAC or 230 VAC
Power consumption	150 W	150 W
Protection classification	IP65	IP65
Weight (full reservoir)	20 kg (44.1 lb)	28 kg (61.7 lb)
Height of pump	448 mm (17.64 in.)	688 mm (27.09 in.)
Width of pump	230 mm (9.06 in.)	230 mm (9.06 in.)
Depth of pump	235 mm (9.25 in.)	235 mm (9.25 in.)
Material	Aluminium	Aluminium

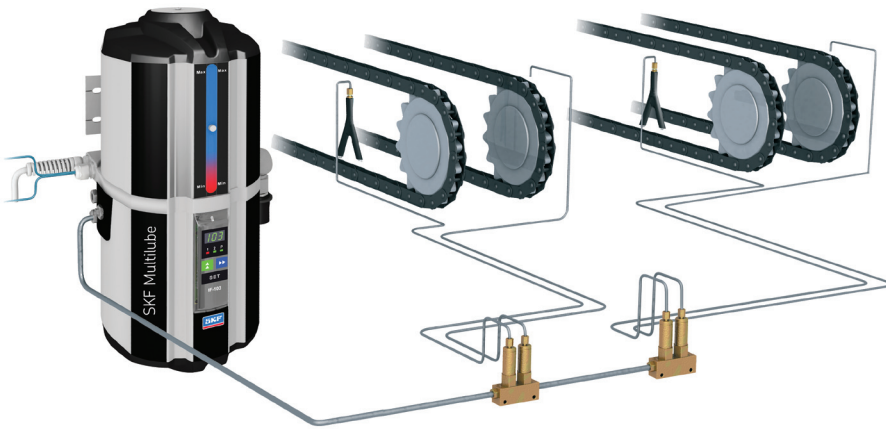

Single line centralised lubrication system with OS dosers

Lubricant oil
 OS doser range 0,3 – 2,0 cm³
 Dual lubrication channel available

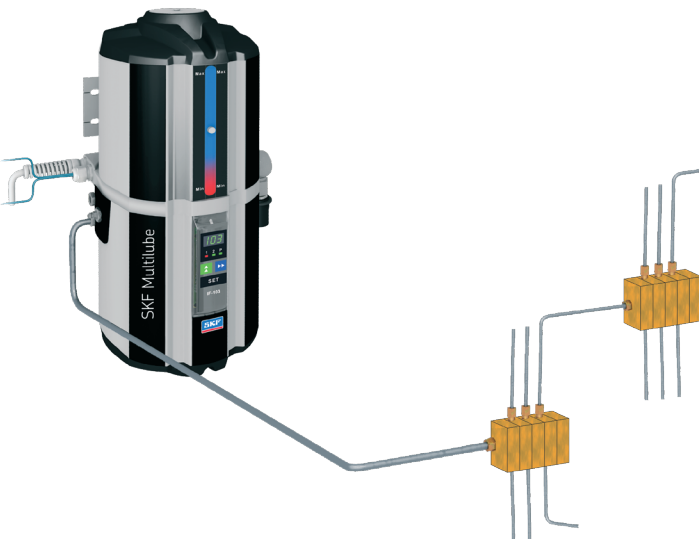

Pumping unit with progressive distributors

Lubricant greases NLGI 000 – NLGI 2
 VPB distributor range 0,2 cm³
 VPK distributor range 0,05–0,6 cm³
 Dual lubrication channel available

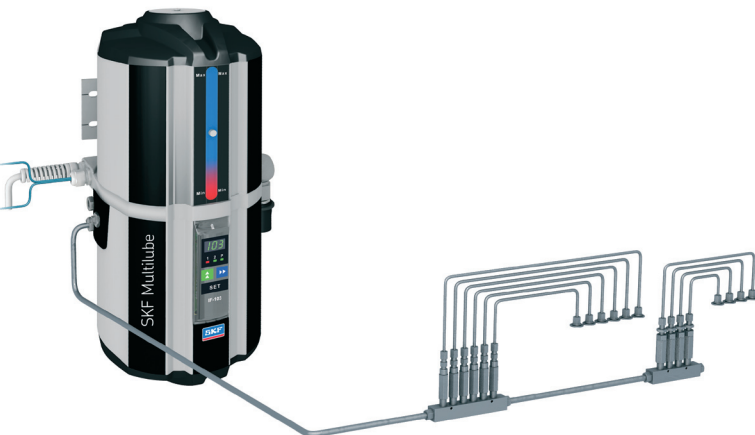

Single line centralised lubrication system with LG and B dosers

Lubricant greases NLGI 000 – NLGI 1 and oils
 LG and B doser range 0,02 – 0,50 cm³
 Dual lubrication channel available

User interface IF-103

Lubrication cycle	1 min to 999 h
Max pressurization time	1 to 999 s
Functions	Setting lubrication cycle Setting max. pressurisation time Setting pressure limits Extra lubrication
Indicator lights	Green, pressurisation Red, alarm
Buttons	Scrolling display Changing set values
Display	Pressurisation interval per line Pressurisation time per line Pressure per line Alarm type Lubrication cycle counter Interlocking
Alarms	Reservoir low level alarm Pressure alarm per line
Protection	Changing set values is password protected



An integrated user interface

The SKF Multilube pumping unit is controlled by a built-in user interface, which makes it simple to use the system and adjust its functions.

It is also possible to control the system externally with SKF multi-channel control centres, or a customer's PLC or process control system. Remote monitoring and control can also be realised using SMS text messages by creating a connection between a GSM modem which is installed on the pump unit and a GSM mobile phone.

The SKF Multilube pumping unit is a financially justified solution for centralised lubrication in order to improve the runnability of production processes.

Designation system for SKF Multilube Pumping Unit MLP

Example: MLP-10-2-230-IF103-PSE	MLP - 10 - 2 - 230 - IF103 - PSE
Identification of product design	MLP SKF Multilube Pump
Identification of reservoir size	4 4 litres 10 10 litres
Identification of number of lines	1 Single line system 2 Dual line system
Identification of power supply	24 24 V control voltage if external control is used 115 Power input 115 V 230 Power input 230 V
Identification of user interface	IF103 User interface 24 External control, control voltage 24 V DC 115 External control, control voltage 115 V AC
Identification of pressure control	PSE Built-in pressure sensor C2 Single line dual channel lubrication pump used with spring distributors C2P Progressive dual channel lubrication pump used with progressive divider E ATEX Certified version for Zone 20 & 22 More detailed information from SKF Muurame

Advantages and features

- Compact all-in-one structure
- Modular and durable design
- Easy to install and start-up
- Can be used in single line, dual line and progressive lubrication systems
- SKF Multilube pumping unit can be used in oil and grease lubrication systems
- Suits all pumpable oils and greases
- Two reservoir sizes
- Pumping element equipped with pressure relief valve
- Filling connection equipped with safety valve
- Visual and electric low level monitoring in reservoir
- Pumping centre is equipped with heating resistor
- Clear and versatile user interface
- Wide operating temperature range -30 to +70 °C (-22 to +158 °F)

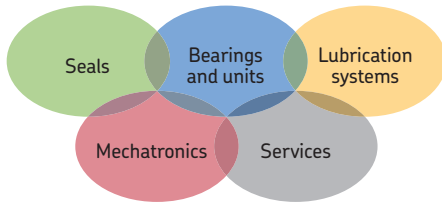

The Power of Knowledge Engineering

Drawing on five areas of competence and application-specific expertise amassed over 100 years, SKF brings innovative solutions to OEMs and production facilities in every major industry worldwide.

These five competence areas include bearings and units, seals, lubrication systems, mechatronics (combining mechanics and electronics into intelligent systems), and a wide range of services, from 3-D computer modelling to advanced condition monitoring and reliability and asset management systems.

A global presence provides SKF customers uniform quality standards and universal product availability.

SKF Lubrication Solutions

e-mail: skf-lube@skf.com

© SKF is a registered trademark of the SKF Group

© SKF Group 2011

The contents of this publication are the copyright of the publisher and may not be reproduced (even extracts) unless permission is granted. Every care has been taken to ensure the accuracy of the information contained in this publication but no liability can be accepted for any loss or damage whether direct, indirect or consequential arising out of the use of the information contained herein.

Publication 6407/II EN • April 2011

Printed in Sweden on environmentally friendly paper.

